

INSTALLING CABLE AND CHAIN

Look in the box for:

Trolley Shaft/Chain Assembly

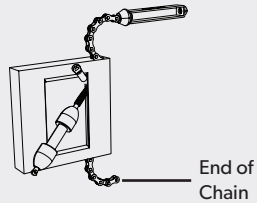

Master Link



⚠ WARNING



To prevent **SERIOUS INJURY**:

- DO NOT connect power until instructed.
- Keep hands and fingers clear from sprocket during operation.
- Wear gloves when installing chain and cable.
- Keep hands and fingers away from joints and possible sharp edges.

Loosely attach trolley shaft with chain connector. 5 complete turns will be sufficient.



Align end of chain around sprocket and extend chain past the left side of the chassis, approximately 7" (17.8 cm). Sprocket teeth must engage the chain.

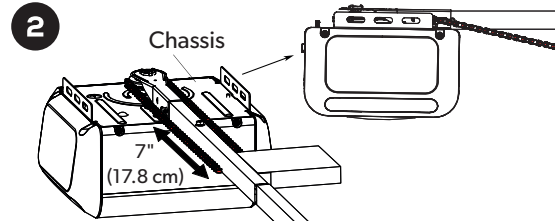

Pull chain with box along the right side of the rail towards trolley and then remove box.

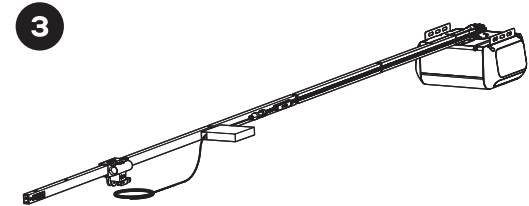

Insert cable through circular hole in trolley. Pull cable through pulley slot and toward power head.

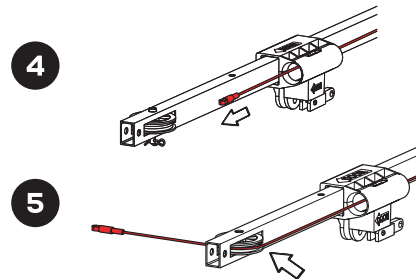

Pull trolley lock lever down to unlock. Insert trolley shaft through the trolley and pull lever back up.

