

CONNECTING PHOTO EYE SAFETY SYSTEM

Look in the box for:

Photo Eyes

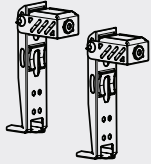

4 x Screws
#12 x 1-1/4"

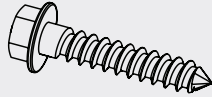

Insulated Staples



⚠ WARNING



To prevent **SERIOUS INJURY** or **DEATH** from electrocution:

- Power **MUST NOT** be connected until instructed.
- The garage door opener will not operate until the photo eye safety system is properly connected and aligned.
- Install the photo eye safety system **NO** higher than 6 inches (15 cm) above the floor.
- No part of garage door or other objects should obstruct the photo eye safety system during door-closing.

Mount photo eyes using #12 x 1-1/4" screws provided.

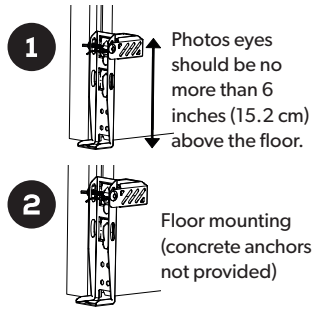

Alternative mounting location:
Door track / wall mounting. Photo eyes should be no more than 6 inches (15.2 cm) above the floor.

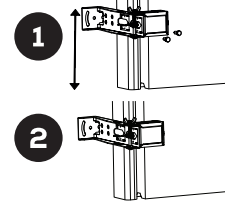

Run wire to power head. Use insulated staples to secure photo eye wires to wall and ceiling. Take care not to puncture the wires while securing staples.

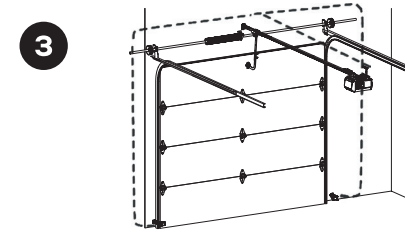

* **VERY IMPORTANT!** *

Strip 7/16 inch (1 cm) of insulation from the end of the wire.

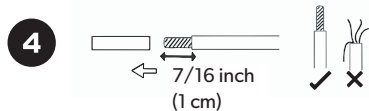

Each pair of terminals **MUST** be connected with one white wire and one striped wire (non-polarized) from the **SAME** photo eye.

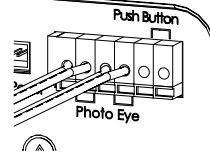

Cut and discard excess wire. Use small flat head screwdriver to push in grey tab on the terminal block located on the rear panel of the power head. Insert 1/2 inch (1.2 cm) of the wire into the terminal while pushing in the tab.

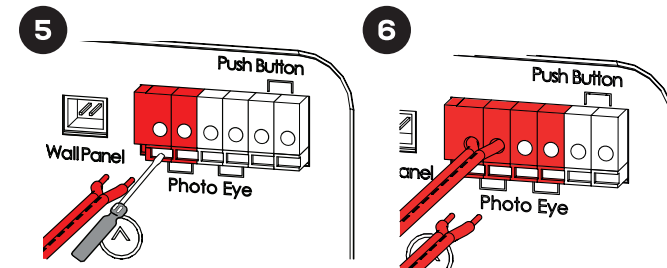

CONNECTING POWER AND ALIGNING PHOTO EYE SAFETY SYSTEM

NOTICE:

The garage door opener cannot be programmed and will not close the door until photo eye safety system are installed and aligned.

WARNING

To prevent SERIOUS INJURY or DEATH from electrocution or fire:

- Power MUST be DISCONNECTED BEFORE proceeding with permanent wiring procedures.
- Garage door opener installation and wiring MUST be in compliance with all local electrical and building codes. Make sure the opener is ALWAYS grounded.
- NEVER use an extension cord, 2-wire adapter or modify the power plug in any way to make it fit the outlet.

To prevent SERIOUS INJURY or DEATH from a closing garage door:

- The photo eye safety system MUST be installed BEFORE connecting power.
- The photo eye safety system MUST be properly connected and aligned BEFORE operating the opener.



1



Right

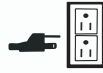

Wrong

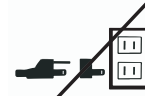

Using the wing nut located on the photo eyes, adjust alignment. When the photo eye safety system is properly aligned the green LED (emitter) will emit a steady green light and the red LED (sensor) will emit a steady red light. The path of the invisible light beam MUST NOT be obstructed. No part of the garage door or any hardware should interfere or block either sensor.

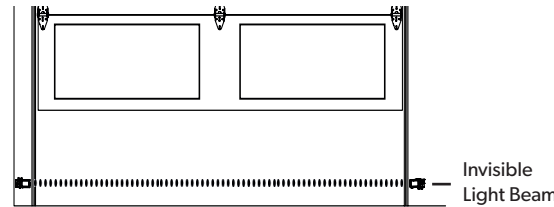
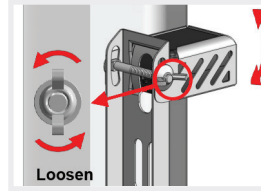

* DO NOT OPERATE OPENER AT THIS TIME *

Plug power head into a grounded outlet ONLY. If there is no grounded outlet present, call a qualified electrician to replace the outlet. Use of a surge protector is highly recommended.

For Permanent Wiring ONLY

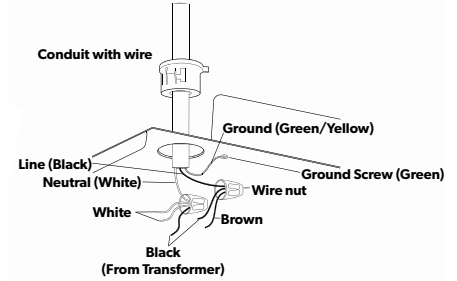

Green LED (emitter) will flash until it is aligned with red LED (sensor). Red LED will not illuminate until it is aligned with green LED.

Emitter
Green LED ON

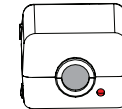

Aligned
Steady Red &
Green LED

Sensor
Red LED ON

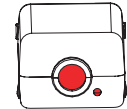

The emitter generates the invisible light beam, and the sensor receives the invisible light beam.